

CROSS-OVER & BAFFLE DETAIL

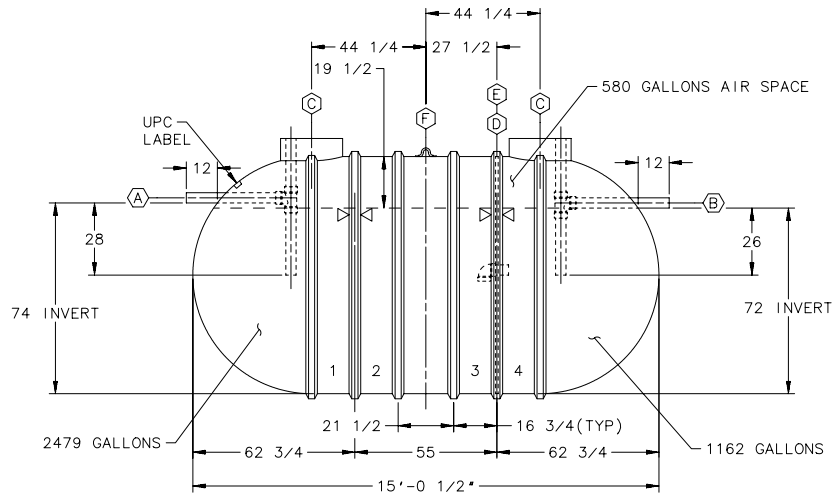

NOTE:

1 - UPC LABEL IS LAMINATED ONTO INLET SIDE OF TANK.

I hereby certify that this plan, specification or report was prepared by me or under my direct supervision and that I am a duly Registered Professional Engineer under the laws of the State of Minnesota

John R. Burwell

Date _____ Reg. No. 24679

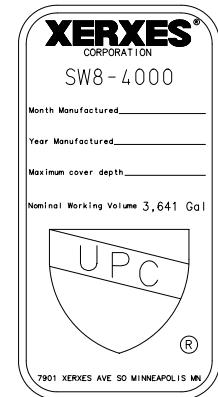

(A)	4"DIA, 6"DIA OR 8"DIA SCH 40 PVC INLET PIPE WITH INTERNAL SANITARY TEE & PIPES
(B)	4"DIA, 6"DIA OR 8"DIA SCH 40 PVC OUTLET PIPE WITH INTERNAL SANITARY TEE & PIPES
(C)	RISER PIPE, FOR 24*(NOMINAL) ACCESS OPENING
(D)	FULL PLATE BAFFLE WITH 1-4 5/8" DIA HOLE (45 3/4" INVERT) & 4" DIA VENT HOLE
(E)	4"DIA SCH 40 PVC CROSS-OVER ELBOW & PIPE
(F)	LIFTING LUG
☒	HOLD DOWN STRAP LOCATION

2	MOVE UPC LABEL	DWG	6-7-06
1	ADD UPC LABEL & CAPACITY DATA	DWG	4-26-06
XERXES CORPORATION			
DR	DATE	TITLE	REV
DAG	4-10-06	8'DIA SWT	
DR	DATE	CAP. 4,000 GALLONS	
		IAPMO	
DR	DATE	DR. SIZE	DR. NUMBER
JEB	4-12-06	D	627-766
SCALE: 1/2"=1'-0"	NEXT ASSY:		SHT 1 OF 1