

CROSS-OVER & BAFFLE DETAIL

NOTE:

1 - UPC LABEL IS LAMINATED ONTO INLET SIDE OF TANK.

I hereby certify that this plan, specification or report was prepared by me or under my direct supervision and that I am a duly Registered Professional Engineer under the laws of the State of Minnesota

John R. Burwell

Date _____ Reg. No. 24679

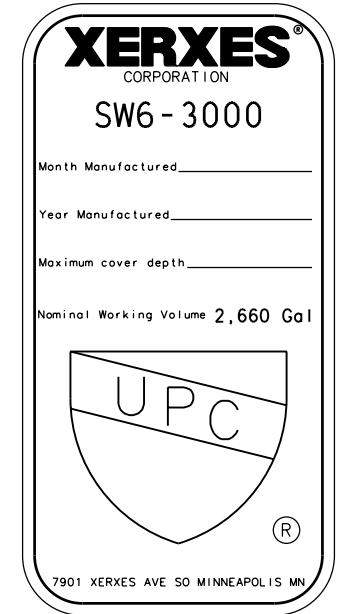
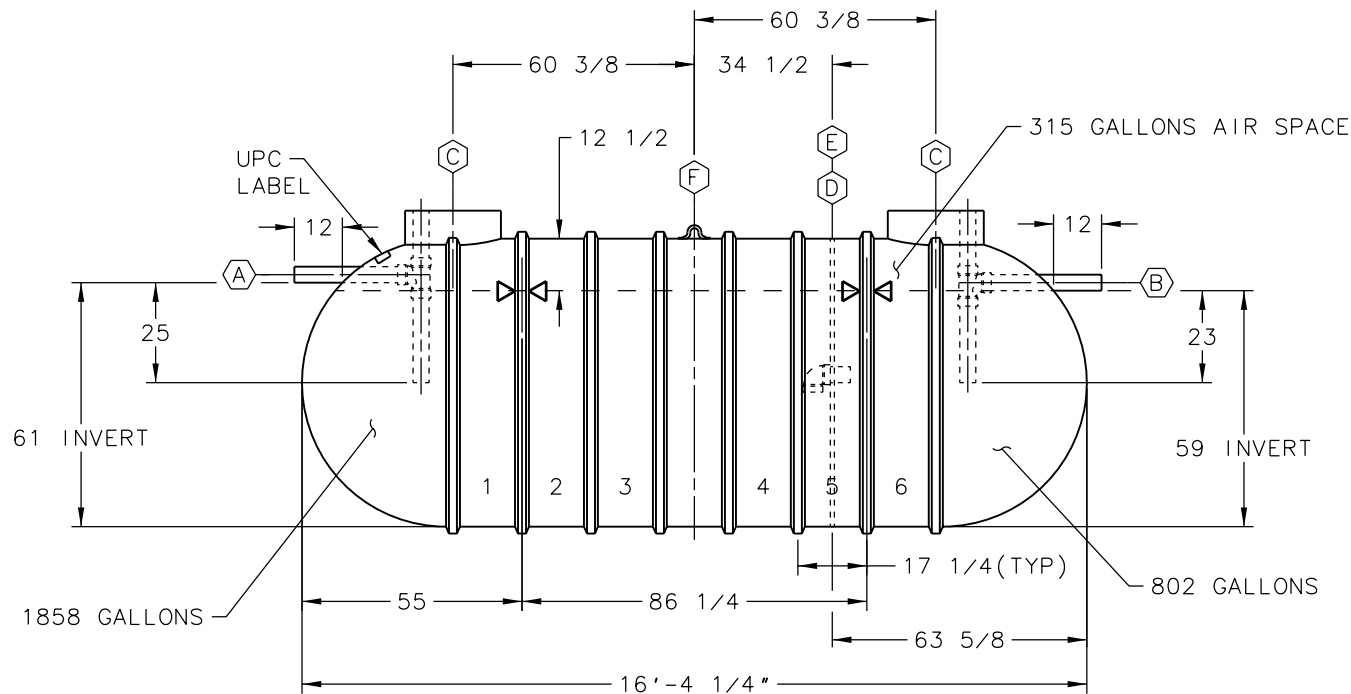

| | |
|-----|--|
| (A) | 4" DIA SCH 40 PVC INLET PIPE WITH INTERNAL SANITARY TEE & PIPES |
| (B) | 4" DIA SCH 40 PVC OUTLET PIPE WITH INTERNAL SANITARY TEE & PIPES |
| (C) | RISER PIPE, FOR 24" (NOMINAL) ACCESS OPENING |
| (D) | FULL PLATE BAFFLE WITH 1-4 5/8" DIA HOLE (35 3/4" INVERT) & 4" DIA VENT HOLE |
| (E) | 4" DIA SCH 40 PVC CROSS-OVER ELBOW & PIPE |
| (F) | LIFTING LUG |
| ⊗ | HOLD DOWN STRAP LOCATION |

| | | | | | | |
|----------------------------|---------|--------------------|------------|------------|--------|--------|
| 2 | | MOVE UPC LABEL | | | | DAG |
| - | | - | | | | 6-7-06 |
| CHK'D | DATE | STD'S | DATE | APPR'D | DATE | |
| - | - | - | - | JB | 6-7-06 | |
| XERXES [®] | | | | | | |
| CORPORATION | | | | | | |
| DRN | DATE | TITLE | | | | |
| DAG | 3-31-06 | 6" DIA SWT | | | | |
| CHK'D | DATE | CAP. 3,000 GALLONS | | | | |
| | | IAPMO | | | | |
| STD'S | DATE | DR. SIZE | DR. NUMBER | REV | | |
| APPR'D | DATE | C | 627-762 | 02 | | |
| JB | 4-10-06 | | | | | |
| SCALE: 1/2" = 1'-0" | | NEXT ASS'Y: - | | SHT 1 OF 1 | | |